



COMMONWEALTH OF KENTUCKY  
TRANSPORTATION CABINET

[www.transportation.ky.gov/](http://www.transportation.ky.gov/)

Andy Beshear  
GOVERNOR

Jim Gray  
SECRETARY

August 16, 2021

CALL NO. 104  
CONTRACT ID NO. 211040  
ADDENDUM # 2

Subject: Warren County, STP 5081 (008)  
Letting August 20, 2021

- (1) Revised - Proposal Bid Items - Pages 173-177 of 177
- (2) Revised - Plan Sheets - R2F, R2G, R59A

Proposal revisions are available at <http://transportation.ky.gov/Construction-Procurement/>.

If you have any questions, please contact us at 502-564-3500.

Sincerely,

Rachel Mills,

A handwritten signature in black ink that reads "Rachel Mills".

Rachel Mills, P.E.  
Director  
Division of Construction Procurement

RM:mr  
Enclosures

**PROPOSAL BID ITEMS**

211040

Page 1 of 5

Report Date 8/16/21

**Section: 0001 - PAVING**

LINE	BID CODE	ALT	DESCRIPTION	QUANTITY	UNIT	UNIT PRIC	FP	AMOUNT
0010	00003		CRUSHED STONE BASE	39,744.00	TON		\$	
0020	00020		TRAFFIC BOUND BASE	1,757.00	TON		\$	
0030	00078		CRUSHED AGGREGATE SIZE NO 2	75,307.00	TON		\$	
0040	00100		ASPHALT SEAL AGGREGATE	237.00	TON		\$	
0050	00103		ASPHALT SEAL COAT	29.00	TON		\$	
0060	00190		LEVELING & WEDGING PG64-22	495.00	TON		\$	
0070	00214		CL3 ASPH BASE 1.00D PG64-22	47,215.00	TON		\$	
0080	00388		CL3 ASPH SURF 0.38B PG64-22	10,925.00	TON		\$	
0090	02602		FABRIC-GEOTEXTILE CLASS 1	218,280.00	SQYD		\$	
0100	02676		MOBILIZATION FOR MILL & TEXT	1.00	LS		\$	
0110	02677		ASPHALT PAVE MILLING & TEXTURING	105.00	TON		\$	
0120	20071EC		JOINT ADHESIVE	99,400.00	LF		\$	
0130	24970EC		ASPHALT MATERIAL FOR TACK NON-TRACKING	147.00	TON		\$	

**Section: 0002 - ROADWAY**

LINE	BID CODE	ALT	DESCRIPTION	QUANTITY	UNIT	UNIT PRIC	FP	AMOUNT
0140	00003		CRUSHED STONE BASE	25.00	TON		\$	
0150	00078		CRUSHED AGGREGATE SIZE NO 2	117.00	TON		\$	
0160	01000		PERFORATED PIPE-4 IN	58.00	LF		\$	
0170	01010		NON-PERFORATED PIPE-4 IN	92.00	LF		\$	
0180	01032		PERF PIPE HEADWALL TY 4-4 IN	2.00	EACH		\$	
0190	01789		RECONSTRUCT MANHOLE	3.00	EACH		\$	
0200	01792		ADJUST MANHOLE	6.00	EACH		\$	
0210	01810		STANDARD CURB AND GUTTER	244.00	LF		\$	
0220	01917		STANDARD BARRIER MEDIAN TYPE 2	723.00	SQYD		\$	
0230	01987		DELINEATOR FOR GUARDRAIL BI DIRECTIONAL WHITE	20.00	EACH		\$	
0240	02091		REMOVE PAVEMENT	204.00	SQYD		\$	
0250	02159		TEMP DITCH	14,200.00	LF		\$	
0260	02200		ROADWAY EXCAVATION	64,100.00	CUYD		\$	
0270	02223		GRANULAR EMBANKMENT	20.00	CUYD		\$	
0280	02242		WATER	5.70	MGAL		\$	
0290	02351		GUARDRAIL-STEEL W BEAM-S FACE	912.50	LF		\$	
0300	02360		GUARDRAIL TERMINAL SECTION NO 1	2.00	EACH		\$	
0310	02367		GUARDRAIL END TREATMENT TYPE 1	2.00	EACH		\$	
0320	02383		REMOVE & RESET GUARDRAIL	200.00	LF		\$	
0330	02429		RIGHT-OF-WAY MONUMENT TYPE 1	122.00	EACH		\$	
0340	02432		WITNESS POST	3.00	EACH		\$	
0350	02469		CLEAN SINKHOLE	1.00	EACH		\$	
0360	02483		CHANNEL LINING CLASS II	440.00	TON		\$	
0370	02545		CLEARING AND GRUBBING 33 ACRES	1.00	LS		\$	
0380	02562		TEMPORARY SIGNS	500.00	SQFT		\$	
0390	02602		FABRIC-GEOTEXTILE CLASS 1	135.00	SQYD		\$	
0400	02603		FABRIC-GEOTEXTILE CLASS 2	34.00	SQYD		\$	

**PROPOSAL BID ITEMS**

211040

Report Date 8/16/21

LINE	BID CODE	ALT	DESCRIPTION	QUANTITY	UNIT	UNIT PRIC	FP	AMOUNT
0410	02604		FABRIC-GEOTEXTILE CLASS 1A	140.00	SQYD		\$	
0420	02650		MAINTAIN & CONTROL TRAFFIC	1.00	LS		\$	
0425	02651		DIVERSIONS (BY-PASS DETOURS) (ADDED 8-16-2021)	1.00	LS		\$	
0430	02671		PORTABLE CHANGEABLE MESSAGE SIGN	2.00	EACH		\$	
0440	02690		SAFELoading	41.40	CUYD		\$	
0450	02701		TEMP SILT FENCE	14,200.00	LF		\$	
0460	02703		SILT TRAP TYPE A	126.00	EACH		\$	
0470	02704		SILT TRAP TYPE B	126.00	EACH		\$	
0480	02705		SILT TRAP TYPE C	88.00	EACH		\$	
0490	02706		CLEAN SILT TRAP TYPE A	377.00	EACH		\$	
0500	02707		CLEAN SILT TRAP TYPE B	377.00	EACH		\$	
0510	02708		CLEAN SILT TRAP TYPE C	283.00	EACH		\$	
0520	02709		CLEAN TEMP SILT FENCE	28,400.00	LF		\$	
0530	02720		SIDEWALK-4 IN CONCRETE	901.00	SQYD		\$	
0540	02726		STAKING	1.00	LS		\$	
0550	02775		ARROW PANEL	2.00	EACH		\$	
0560	05950		EROSION CONTROL BLANKET	18,263.00	SQYD		\$	
0570	05952		TEMP MULCH	303,952.00	SQYD		\$	
0580	05953		TEMP SEEDING AND PROTECTION	13,600.00	SQYD		\$	
0590	05963		INITIAL FERTILIZER	4.20	TON		\$	
0600	05964		MAINTENANCE FERTILIZER	7.00	TON		\$	
0610	05985		SEEDING AND PROTECTION	136,004.00	SQYD		\$	
0620	05990		SODDING	29,025.00	SQYD		\$	
0630	05992		AGRICULTURAL LIMESTONE	85.00	TON		\$	
0640	06510		PAVE STRIPING-TEMP PAINT-4 IN	50,000.00	LF		\$	
0650	06514		PAVE STRIPING-PERM PAINT-4 IN	78,660.00	LF		\$	
0660	06565		PAVE MARKING-THERMO X-WALK-6 IN	384.00	LF		\$	
0670	06567		PAVE MARKING-THERMO STOP BAR-12IN	5.00	LF		\$	
0680	06568		PAVE MARKING-THERMO STOP BAR-24IN	421.00	LF		\$	
0690	06570		PAVE MARKING-PAINT CROSS-HATCH	2,585.00	SQFT		\$	
0700	06574		PAVE MARKING-THERMO CURV ARROW	89.00	EACH		\$	
0710	06575		PAVE MARKING-THERMO COMB ARROW	3.00	EACH		\$	
0720	06578		PAVE MARKING-THERMO MERGE ARROW	4.00	EACH		\$	
0730	06601NC		PAVE MARKING-PAINT WORDS	22.00	EACH		\$	
0740	10020NS		FUEL ADJUSTMENT	62,732.00	DOLL	\$1.00	\$	\$62,732.00
0750	10030NS		ASPHALT ADJUSTMENT	104,652.00	DOLL	\$1.00	\$	\$104,652.00
0760	20430ED		SAW CUT	313.00	LF		\$	
0770	20782NS714		PAVE MARKING THERMO-BIKE	1.00	EACH		\$	
0775	21289ED		LONGITUDINAL EDGE KEY (ADDED 8-16-21)	28,400.00	LF		\$	
0780	22664EN		WATER BLASTING EXISTING STRIPE	500.00	LF		\$	
0790	23158ES505		DETECTABLE WARNINGS	71.00	SQFT		\$	
0800	23274EN11F		TURF REINFORCEMENT MAT 1	4,395.00	SQYD		\$	
0810	24489EC		INLAID PAVEMENT MARKER	1,032.00	EACH		\$	

**Section: 0003 - DRAINAGE**

LINE	BID CODE	ALT	DESCRIPTION	QUANTITY	UNIT	UNIT PRIC	FP	AMOUNT
------	----------	-----	-------------	----------	------	-----------	----	--------

**PROPOSAL BID ITEMS**

211040

Report Date 8/16/21

LINE	BID CODE	ALT	DESCRIPTION	QUANTITY	UNIT	UNIT PRIC	FP	AMOUNT
0820	00439		ENTRANCE PIPE-12 IN	167.00	LF		\$	
0830	00440		ENTRANCE PIPE-15 IN	876.00	LF		\$	
0840	00441		ENTRANCE PIPE-18 IN	793.00	LF		\$	
0850	00443		ENTRANCE PIPE-24 IN	547.00	LF		\$	
0860	00452		ENTRANCE PIPE-24 IN EQUIV	120.00	LF		\$	
0870	00462		CULVERT PIPE-18 IN	281.00	LF		\$	
0880	00464		CULVERT PIPE-24 IN	148.00	LF		\$	
0890	00466		CULVERT PIPE-30 IN	180.00	LF		\$	
0900	00470		CULVERT PIPE-48 IN	132.00	LF		\$	
0910	00494		CULVERT PIPE-30 IN EQUIV	88.00	LF		\$	
0920	00499		CULVERT PIPE-48 IN EQUIV	24.00	LF		\$	
0930	00522		STORM SEWER PIPE-18 IN	246.00	LF		\$	
0940	00524		STORM SEWER PIPE-24 IN	73.00	LF		\$	
0950	01216		PIPE CULVERT HEADWALL-48 IN	2.00	EACH		\$	
0960	01217		PIPE CULVERT HEADWALL-48 IN EQUIV	2.00	EACH		\$	
0970	01450		S & F BOX INLET-OUTLET-18 IN	8.00	EACH		\$	
0980	01451		S & F BOX INLET-OUTLET-24 IN	6.00	EACH		\$	
0990	01452		S & F BOX INLET-OUTLET-30 IN	4.00	EACH		\$	
1000	01453		S & F BOX INLET-OUTLET-36 IN	2.00	EACH		\$	
1010	01756		MANHOLE TYPE A	1.00	EACH		\$	
1020	02200		ROADWAY EXCAVATION	113.00	CUYD		\$	
1030	02484		CHANNEL LINING CLASS III	350.00	TON		\$	
1040	02607		FABRIC-GEOTEXTILE CLASS 2 FOR PIPE	2,260.00	SQYD	\$2.00	\$	\$4,520.00
1050	21799EN		BORE AND JACK PIPE-24 IN	106.00	LF		\$	
1060	23126EN		BORE AND JACK PIPE-18 IN	58.00	LF		\$	
1070	23274EN11F		TURF REINFORCEMENT MAT 1	165.00	SQYD		\$	
1080	24814EC		PIPELINE INSPECTION	1,074.00	LF		\$	

**Section: 0004 - BRIDGE- 27789 - 12' X 8' X 80' PEDESTRIAN UNDERPASS**

LINE	BID CODE	ALT	DESCRIPTION	QUANTITY	UNIT	UNIT PRIC	FP	AMOUNT
1090	08003		FOUNDATION PREPARATION	1.00	LS		\$	
1100	08100		CONCRETE-CLASS A	171.70	CUYD		\$	
1110	08150		STEEL REINFORCEMENT	25,032.00	LB		\$	

**Section: 0005 - BRIDGE- 27506 - 5' X 4' EXTENSION (31'-9" INLET 35'-6" OUTLET)**

LINE	BID CODE	ALT	DESCRIPTION	QUANTITY	UNIT	UNIT PRIC	FP	AMOUNT
1120	02625		REMOVE HEADWALL	2.00	EACH		\$	
1130	08003		FOUNDATION PREPARATION	1.00	LS		\$	
1140	08100		CONCRETE-CLASS A	66.90	CUYD		\$	
1150	08150		STEEL REINFORCEMENT	5,492.00	LB		\$	

**Section: 0006 - BRIDGE-27507 - 5' X 3' EXTENSION (34'-6" INLET 33'-6" OUTLET)**

LINE	BID CODE	ALT	DESCRIPTION	QUANTITY	UNIT	UNIT PRIC	FP	AMOUNT
------	----------	-----	-------------	----------	------	-----------	----	--------

**PROPOSAL BID ITEMS**

211040

Page 4 of 5

Report Date 8/16/21

LINE	BID CODE	ALT	DESCRIPTION	QUANTITY	UNIT	UNIT PRIC	FP	AMOUNT
1160	02625		REMOVE HEADWALL	2.00	EACH		\$	
1170	08003		FOUNDATION PREPARATION	1.00	LS		\$	
1180	08100		CONCRETE-CLASS A	54.70	CUYD		\$	
1190	08150		STEEL REINFORCEMENT	3,644.00	LB		\$	

**Section: 0007 - SEWER**

LINE	BID CODE	ALT	DESCRIPTION	QUANTITY	UNIT	UNIT PRIC	FP	AMOUNT
1200	00003		CRUSHED STONE BASE	50.00	TON		\$	
1210	00388		CL3 ASPH SURF 0.38B PG64-22	8.00	TON		\$	
1220	15010		S CONCRETE PIPE ANCHOR	3.00	EACH		\$	
1230	15020		S ENCASEMENT STEEL OPEN CUT RANGE 1	50.00	LF		\$	
1240	15026		S FORCE MAIN AIR RLS/VAC VLV 02 IN	1.00	EACH		\$	
1250	15068		S FORCE MAIN SPECIAL	260.00	LF		\$	
1260	15071		S FORCE MAIN TIE-IN 02 INCH	1.00	EACH		\$	
1270	15084		S FORCE MAIN VALVE GATE	1.00	EACH		\$	
1280	15094		S MANHOLE ADJUST TO GRADE INSTALL GRADE RINGS ON CONE	4.00	EACH		\$	
1290	15094		S MANHOLE ADJUST TO GRADE REM CONE INTALL NEW BARREL SECTION	3.00	EACH		\$	
1300	15094		S MANHOLE ADJUST TO GRADE REPLACE BARREL SECTION LOWER .3 VF	1.00	EACH		\$	
1310	15096		S MANHOLE CASTING WATERTIGHT	1.00	EACH		\$	
1320	15119		S PUMP STATION	1.00	EACH		\$	

**Section: 0008 - SIGNING**

LINE	BID CODE	ALT	DESCRIPTION	QUANTITY	UNIT	UNIT PRIC	FP	AMOUNT
1330	06406		SBM ALUM SHEET SIGNS .080 IN	248.00	SQFT		\$	
1340	06407		SBM ALUM SHEET SIGNS .125 IN	78.00	SQFT		\$	
1350	06410		STEEL POST TYPE 1	740.00	LF		\$	
1360	21373ND		REMOVE SIGN	6.00	EACH		\$	
1370	21813NN		REMOVE AND RELOCATE SHEET SIGNS	13.00	EACH		\$	
1380	24631EC		BARCODE SIGN INVENTORY	77.00	EACH		\$	

**Section: 0009 - SIGNALIZATION**

LINE	BID CODE	ALT	DESCRIPTION	QUANTITY	UNIT	UNIT PRIC	FP	AMOUNT
1390	04811		ELECTRICAL JUNCTION BOX TYPE B	3.00	EACH		\$	
1400	04820		TRENCHING AND BACKFILLING	285.00	LF		\$	
1410	04844		CABLE-NO. 14/5C	4,155.00	LF		\$	
1420	04885		MESSENGER-10800 LB	1,675.00	LF		\$	
1430	04932		INSTALL STEEL STRAIN POLE	12.00	EACH		\$	
1440	04953		TEMP RELOCATION OF SIGNAL HEAD	42.00	EACH		\$	
1450	20093NS835		INSTALL PEDESTRIAN HEAD-LED	4.00	EACH		\$	
1460	20188NS835		INSTALL LED SIGNAL-3 SECTION	17.00	EACH		\$	
1470	20266ES835		INSTALL LED SIGNAL- 4 SECTION	3.00	EACH		\$	

**PROPOSAL BID ITEMS**

211040

Page 5 of 5

Report Date 8/16/21

LINE	BID CODE	ALT	DESCRIPTION	QUANTITY	UNIT	UNIT PRIC	FP	AMOUNT
1480	20390NS835		INSTALL COORDINATING UNIT	2.00	EACH		\$	
1490	21743NN		INSTALL PEDESTRIAN DETECTOR	4.00	EACH		\$	
1500	23157EN		TRAFFIC SIGNAL POLE BASE	51.00	CUYD		\$	
1510	23222EC		INSTALL SIGNAL PEDESTAL	3.00	EACH		\$	
1520	24601EC		INSTALL SOLAR SCHOOL FLASHER	2.00	EACH		\$	
1530	24900EC		PVC CONDUIT-1 1/4 IN-SCHEDULE 80	125.00	LF		\$	
1540	24901EC		PVC CONDUIT-2 IN-SCHEDULE 80	160.00	LF		\$	
1550	24908EC		INSTALL SIGNAL CONTROLLER-TY ATC	2.00	EACH		\$	
1560	24955ED		REMOVE SIGNAL EQUIPMENT	4.00	EACH		\$	
1570	26119EC		INSTALL RADAR PRESENCE DETECTOR TYPE A	8.00	EACH		\$	
1580	26120EC		INSTALL RADAR ADVANCE DETECTOR TYPE B	4.00	EACH		\$	

**Section: 0010 - DEMOBILIZATION &/OR MOBILIZATION**

LINE	BID CODE	ALT	DESCRIPTION	QUANTITY	UNIT	UNIT PRIC	FP	AMOUNT
1590	02568		MOBILIZATION	1.00	LS		\$	
1600	02569		DEMOBILIZATION	1.00	LS		\$	

**GENERAL SUMMARY**

ITEM	DESCRIPTION	UNIT	US 31W	S MELWAIN RD	S GLEN BLDV	KY 242 WEST	KY 242 EAST	FULLER DRIVE	MOREHEAD ROAD	MEGAN COURT	BOWIE AVENUE	MULTIPLE USE PATH	TOTAL PROJECT
3	CRUSHED STONE BASE	TON	25										25
76	CRUSHED AGGREGATE SIZE NO 2	TON	117										117
1000	PERFORATED PIPE-4 INCH	LIN FT	58										58
1010	NON-PERFORATED PIPE-4 INCH	LIN FT	92										92
1032	PERFORATED PIPE HEADWALL TY 4 - 4 INCH	EACH	2										2
1810	STANDARD CURB AND GUTTER	LIN FT	91										244
1917	STANDARD BARRIER MEDIAN TYPE 2	SO YD	723	153									723
1987	DELINEATOR FOR GUARDRAIL BI-DIRECTIONAL WHITE	EACH	20										20
20430ED	SAWCUT	LIN FT	313										313
2091	REMOVE PAVEMENT	SO YD	204										204
2159	TEMPORARY DITCH	LIN FT	14200										14200
2160	CLEAN TEMPORARY DITCH	LIN FT	28400										28400
2220	ROADWAY EXCAVATION	CU YD	54464	1048	5	153	716	86	277	92	118	1108	64100
2223	GRANULAR EMBANKMENT	CU YD	20										20
2242	WATER	MGAL	5.7										5.7
2351	GUARDRAIL STEEL W BEAM - S FACE	LIN FT	912.5										912.5
2360	GUARDRAIL TERMINAL SECTION NO 1	EACH	2										2
2367	GUARDRAIL END TREATMENT TYPE 1	EACH	2										2
2383	REMOVE & RESET GUARDRAIL	LIN FT	200										200
2429	RIGHT-OF-WAY MONUMENT TYPE 1	EACH	122										122
2432	WITNESS POST	EACH	3										3
2469	CLEAN SINKHOLE	EA	1										1
2483	CHANNEL LINING CLASS II	TONS	90										440
2545	CLEARING AND GRUBBING	LP SUM	1										1
2562	SIGNS	SO FT	500										500
2568	MOBILIZATION	LP SUM	1										1
2569	DEMOBILIZATION	LP SUM	1										1
2604	GEOTEXTILE FABRIC CLASS 1A	SO YD	140										140
2602	GEOTEXTILE FABRIC CLASS 1	SO YD	135										135
2603	GEOTEXTILE FABRIC CLASS 2	SO YD	34										34
2650	MAINTAIN AND CONTROL TRAFFIC	LP SUM	1										1
2651	DIVERSIONS (BY-PASS DETOURS)	EACH	1										1
2671	PORTABLE AND CHANGEABLE MESSAGE SIGN	EACH	2										2
2677	ASPHALT PAVE MILLING & TEXTURING	TONS		.12	.28	.26		.15	.14	.15	.18		1.28
2690	SAFELOADING	CU YD	41.4										41.4
2701	TEMPORARY SILT FENCE	LIN FT	14200										14200
2703	SILT TRAP TYPE A	EACH	126										126
2704	SILT TRAP TYPE B	EACH	126										126
2705	SILT TRAP TYPE C	EACH	88										88
2706	CLEAN SILT TRAP TYPE A	EACH	377										377
2707	CLEAN SILT TRAP TYPE B	EACH	377										377
2708	CLEAN SILT TRAP TYPE C	EACH	283										283
2720	SIDEWALK-4 IN CONCRETE	SO YD	803		60		38						901
2726	STAKING	LP SUM	1										1
2775	ARROW PANEL	EACH	2										2
5950	EROSION CONTROL BLANKET	SO YD	14610	148		85			410		130	2880	18263
5952	TEMPORARY MULCH	SO YD	303952										303952
5953	TEMPORARY SEEDING AND PROTECTION	SO YD	13600										13600
5963	INITIAL FERTILIZER	TON	4.2										4.2

**NOTES:**

- ① INCLUDES REMOVING PAVEMENT, GRADING TO DRAIN AND SEEDING AREA
- ② INCLUDES 5920 CU YD EMBANKMENT FOUNDATION BENCHING
- ③ FOR CONTROLLING DUST CAUSED BY MAINTAINING TRAFFIC ONLY, (ESTIMATED AT 2.125M GAL/MILE)
- ④ 113 CU YD CARRIED FORWARD FROM THE PIPE DRAINAGE SUMMARY
- ⑤ 350 TONS CARRIED FORWARD FROM THE PIPE DRAINAGE SUMMARY
- ⑥ APPROXIMATELY 33 ACRES.
- ⑦ TEMPORARY SIGNS
- ⑧ TO BE LOCATED BY THE CONSTRUCTION ENGINEER
- ⑨ APPLY AT RATE OF 300 LBS/ACRE
- ⑩ 1.28 TONS CARRIED FORWARD TO THE PAVEMENT SUMMARY

**TOTAL PROJECT EARTHWORK**

54808	CU YD	EMB
5920	CU YD	EMB BENCH
58148	CU YD	COM

**GENERAL SUMMARY**

**REVISED 8/16/21**

**NOTES:**

- ① INCLUDES REMOVING PAVEMENT, GRADING TO DRAIN AND SEEDING AREA
- ② INCLUDES 5920 CU YD EMBANKMENT FOUNDATION BENCHING
- ③ FOR CONTROLLING DUST CAUSED BY MAINTAINING TRAFFIC ONLY, (ESTIMATED AT 2.125M GAL/MILE)
- ④ 113 CU YD CARRIED FORWARD FROM THE PIPE DRAINAGE SUMMARY
- ⑤ 350 TONS CARRIED FORWARD FROM THE PIPE DRAINAGE SUMMARY
- ⑥ APPROXIMATELY 33 ACRES.
- ⑦ TEMPORARY SIGNS
- ⑧ TO BE LOCATED BY THE CONSTRUCTION ENGINEER
- ⑨ APPLY AT RATE OF 300 LBS/ACRE
- ⑩ 1.28 TONS CARRIED FORWARD TO THE PAVEMENT SUMMARY

TOTAL PROJECT EARTHWORK

54808 CU YD EMB  
 5920 CU YD EMB BENCH  
 58148 CU YD COM

ITEM	DESCRIPTION	UNIT	US 31W	S MCELWAIN RD	S GLEN GABLES BLVD	KY 242 WEST	KY 242 EAST	FULLER DRIVE	MOREHEAD ROAD	MEGAN COURT	BOWIE AVENUE	MULTIPLE USE PATH	TOTAL PROJECT
3	CRUSHED STONE BASE	TON	25										25
76	CRUSHED AGGREGATE SIZE NO 2	TON	117										117
1000	PERFORATED PIPE-4 INCH	LIN FT	58										58
1010	NON-PERFORATED PIPE-4 INCH	LIN FT	92										92
1032	PERFORATED PIPE HEADWALL TX 4 - 4 INCH	EACH	2										2
1810	STANDARD CURB AND GUTTER	LIN FT	91	153									244
1917	STANDARD BARRIER MEDIAN TYPE 2	SO YD	723										723
1987	DELINEATOR FOR GUARDRAIL BI-DIRECTIONAL WHITE	EACH	20										20
20430ED	SAWCUT	LIN FT	313										313
2091	REMOVE PAVEMENT	SO YD	204										204
2159	TEMPORARY DITCH	LIN FT	14200										14200
2160	CLEAN TEMPORARY DITCH	LIN FT	28400										28400
2220	ROADWAY EXCAVATION	CU YD	54464	1048	5	153	716	86	277	92	118	1108	64100
2223	GRANULAR EMBANKMENT	CU YD	20										20
2242	WATER	M GAL	5.7										5.7
2351	GUARDRAIL STEEL W BEAM - S FACE	LIN FT	912.5										912.5
2360	GUARDRAIL TERMINAL SECTION NO 1	EACH	2										2
2367	GUARDRAIL END TREATMENT TYPE 1	EACH	2										2
2383	REMOVE & RESET GUARDRAIL	LIN FT	200										200
2429	RIGHT-OF-WAY MONUMENT TYPE 1	EACH	122										122
2432	WITNESS POST	EACH	3										3
2469	CLEAN SINKHOLE	EA	1										1
2483	CHANNEL LINING CLASS II	TONS	90										90
2545	CLEARING AND GRUBBING	LP SUM	1										1
2562	SIGNS	SO FT	500										500
2568	MOBILIZATION	LP SUM	1										1
2569	DEMOBILIZATION	LP SUM	1										1
2604	GEOTEXTILE FABRIC CLASS 1A	SO YD	140										140
2602	GEOTEXTILE FABRIC CLASS 1	SO YD	135										135
2603	GEOTEXTILE FABRIC CLASS 2	SO YD	34										34
2650	MAINTAIN AND CONTROL TRAFFIC	LP SUM	1										1
2651	DIVERSIONS (BY-PASS DETOURS)	EACH	1										1
2671	PORTABLE AND CHANGEABLE MESSAGE SIGN	EACH	2										2
2677	ASPHALT PAVE MILLING & TEXTURING	TONS	.12	.28	.26	.15	.14	.15	.15	.15	.18		1.28
2690	SAFELADING	CU YD	41.4										41.4
2701	TEMPORARY SILT FENCE	LIN FT	14200										14200
2703	SILT TRAP TYPE A	EACH	126										126
2704	SILT TRAP TYPE B	EACH	126										126
2705	SILT TRAP TYPE C	EACH	88										88
2706	CLEAN SILT TRAP TYPE A	EACH	377										377
2707	CLEAN SILT TRAP TYPE B	EACH	377										377
2708	CLEAN SILT TRAP TYPE C	EACH	283										283
2720	SIDEWALK-4 IN CONCRETE	SO YD	803	60		38							901
2726	STAKING	LP SUM	1										1
2775	ARROW PANEL	EACH	2										2
5950	EROSION CONTROL BLANKET	SO YD	14610	148	85		410				130	2880	18263
5952	TEMPORARY MULCH	SO YD	303952										303952
5953	TEMPORARY SEEDING AND PROTECTION	SO YD	13600										13600
5963	INITIAL FERTILIZER	TON	4.2										4.2

**GENERAL SUMMARY**



**GENERAL SUMMARY**

**NOTES:**

- (11) APPLY AT RATE OF 3 TONS/ACRE
- (12) 165 SQ YD CARRIED FORWARD FROM THE PIPE DRAINAGE SUMMARY
- (13) INCLUDES [PAVEMENT MARKER TYPE V-MW (403 EACH)  
PAVEMENT MARKER TYPE V-BY (629 EACH)]

ITEM	DESCRIPTION	UNIT	US 31W	S MELWAIN RD	S GLEN GABLES BLVD	KY 242 WEST	KY 242 EAST	FULLER DRIVE	MOREHEAD ROAD	MEGAN COURT	BOWIE AVENUE	MULTIPLE USE PATH	TOTAL PROJECT
5964	MAINTENANCE FERTILIZER	TONS	7										7
5985	SEEDING AND PROTECTION	SO YD	136004										136004
5990	SODDING	SO YD	27475	135	335	270	310	235			265		29025
5992	AGRICULTURAL LIMESTONE	TON	85										85
6510	PAVEMENT STRIPING - TEMPORARY 4 IN	LIN FT	50000										50000
6514	PAVEMENT STRIPING - PERM PAINT 4 IN	LIN FT	78660										78660
6565	PAVE MARKING-THERMO X-WALK-6 IN	LIN FT	384										384
6567	PAVE MARKING-THERMO STOP BAR-12 IN	LIN FT	5										5
6568	PAVE MARKING-THERMO STOP BAR-24 IN	LIN FT	421										421
6570	PAVE MARKING-PAINT CROSS-HATCH	SO FT	2585										2585
6574	PAVE MARKING-THERMO CURV ARROW	EACH	89										89
6575	PAVE MARKING-THERMO COMB ARROW	EACH	3										3
6578	PAVE MARKING-THERMO MERGE ARROW	EACH	4										4
20782NS714	PAVE MARKING THERMO-BIKE	EACH	1										1
06601NC	PAVE MARKING-PAINT WORD	EACH	22										22
21289ED	LONGITUDINAL EDGE KEY	LIN FT	28400										28400
24489EC	INLAID PAVEMENT MARKER	EACH	1032										1032
10020NS	FUEL ADJUSTMENT	DOLLAR	62732										62732
10030NS	ASPHALT ADJUSTMENT	DOLLAR	104652										104652
23274ENIIF	TURF REINFORCEMENT MAT 1	SO YD	3635			55	70	100	20	100		250	4395
22664EN	WATER BLASTING EXISTING STRIPE	LIN FT	500										500
23158ES505	DETECTABLE WARNINGS	SO FT	17		42		12						71

**GENERAL SUMMARY**

ITEM	DESCRIPTION	UNIT	US 31W	S MELWAIN RD	S GLEN GABLES BLVD	KY 242 WEST	KY 242 EAST	FULLER DRIVE	MOREHEAD ROAD	MEGAN COURT	BOWIE AVENUE	MULTIPLE USE PATH	TOTAL PROJECT
5964	MAINTENANCE FERTILIZER	TONS	7										7
5985	SEEDING AND PROTECTION	SO YD	136004										136004
5990	SODDING	SO YD	27475	135	335	270	310	235			265		29025
5992	AGRICULTURAL LIMESTONE	TON	85										85
6510	PAVEMENT STRIPING - TEMPORARY 4 IN	LIN FT	50000										50000
6514	PAVEMENT STRIPING - PERM PAINT 4 IN	LIN FT	78660										78660
6565	PAVE MARKING-THERMO X-WALK-6 IN	LIN FT	384										384
6567	PAVE MARKING-THERMO STOP BAR-12 IN	LIN FT	5										5
6568	PAVE MARKING-THERMO STOP BAR-24 IN	LIN FT	421										421
6570	PAVE MARKING-PAINT CROSS-HATCH	SO FT	2585										2585
6574	PAVE MARKING-THERMO CURV ARROW	EACH	89										89
6575	PAVE MARKING-THERMO COMB ARROW	EACH	3										3
6578	PAVE MARKING-THERMO MERGE ARROW	EACH	4										4
20782NS714	PAVE MARKING THERMO-BIKE	EACH	1										1
0660INC	PAVE MARKING-PAINT WORD	EACH	22										22
21289ED	LONGITUDINAL EDGE KEY	LIN FT	28400										28400
24789EC	IN-LAID PAVEMENT MARKER	EACH	1032										1032
10020NS	FUEL ADJUSTMENT	DOLLAR	62732										62732
10030NS	ASPHALT ADJUSTMENT	DOLLAR	104652										104652
23274ENIF	TURF REINFORCEMENT MAT 1	SO YD	3635			55	70	100	20	100		250	4395
22664EN	WATER BLASTING EXISTING STRIPE	LIN FT	500										500
23158ES505	DETECTABLE WARNINGS	SO FT	17		42		12						71

**NOTES:**

- (11) APPLY AT RATE OF 3 TONS/ACRE
- (12) 165 SO YD CARRIED FORWARD FROM THE PIPE DRAINAGE SUMMARY
- (13) INCLUDES PAVEMENT MARKER TYPE V-MW (403 EACH) PAVEMENT MARKER TYPE V-BY (629 EACH)

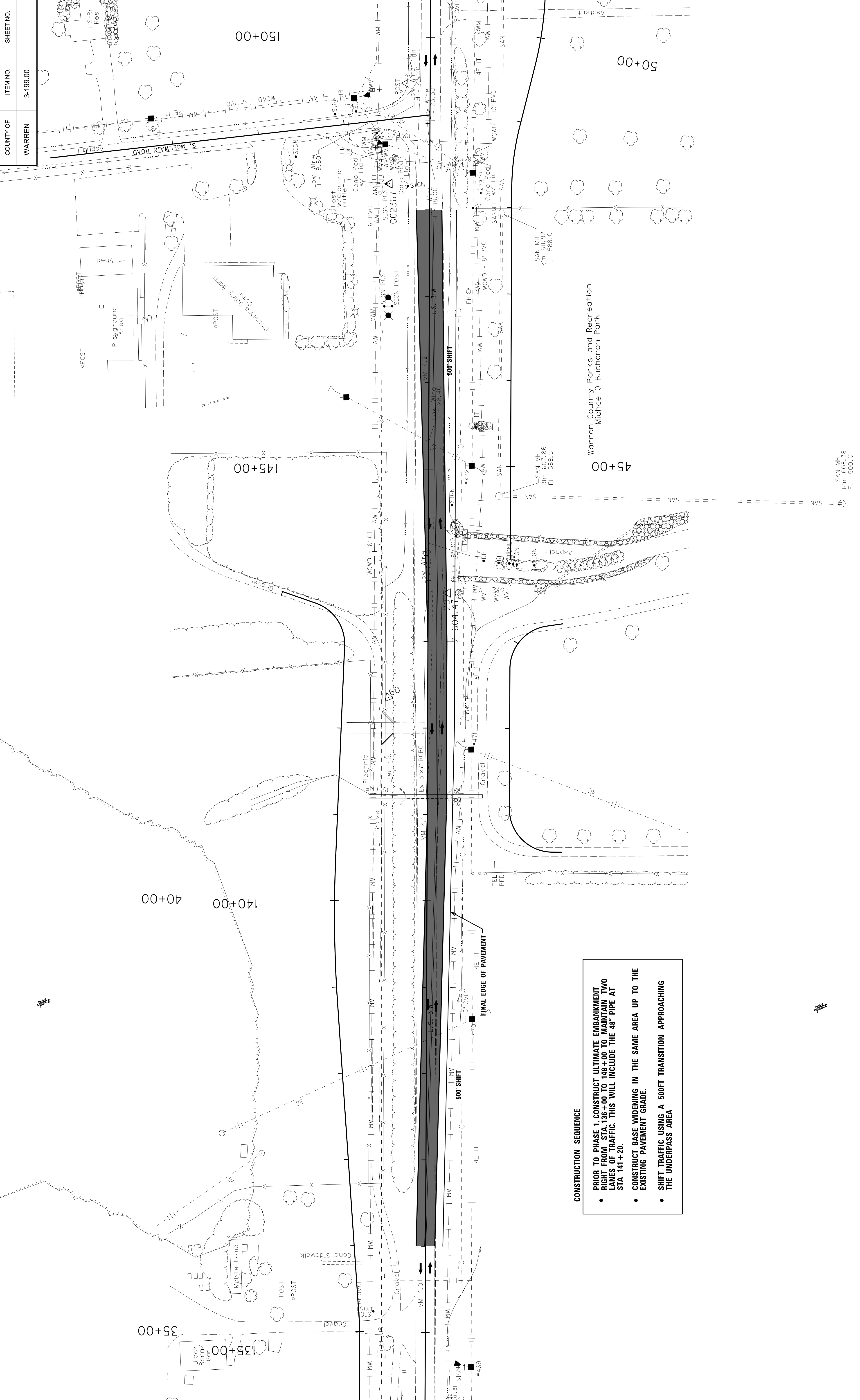

**CONSTRUCTION SEQUENCE**

- PRIOR TO PHASE 1, CONSTRUCT ULTIMATE EMBANKMENT RIGHT FROM STA. 136+00 TO 148+00 TO MAINTAIN TWO LANES OF TRAFFIC. THIS WILL INCLUDE THE 48" PIPE AT STA 141+20.
- CONSTRUCT BASE WIDENING IN THE SAME AREA UP TO THE EXISTING PAVEMENT GRADE.
- SHIFT TRAFFIC USING A 500FT TRANSITION APPROACHING THE UNDERPASS AREA

COUNTY OF	WARREN
ITEM NO.	3-199.00
SHEET NO.	

US 31W WIDENING  
DIVERSION #1  
UNDERPASS

SCALE: 1" = 50'

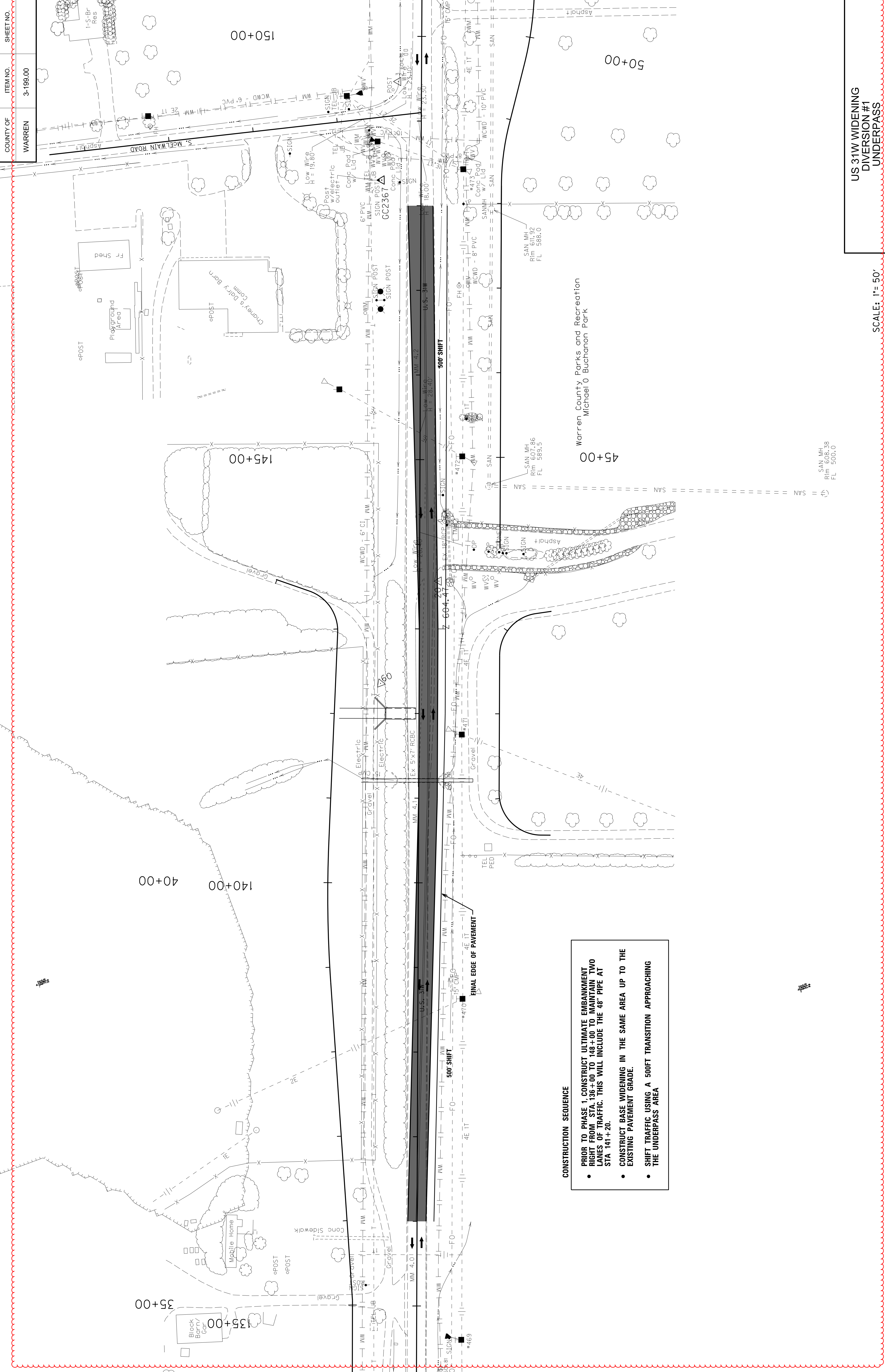

**CONSTRUCTION SEQUENCE**

- PRIOR TO PHASE 1, CONSTRUCT ULTIMATE EMBANKMENT RIGHT FROM STA. 136+00 TO 148+00 TO MAINTAIN TWO LANES OF TRAFFIC. THIS WILL INCLUDE THE 48" PIPE AT STA 141+20.
- CONSTRUCT BASE WIDENING IN THE SAME AREA UP TO THE EXISTING PAVEMENT GRADE.
- SHIFT TRAFFIC USING A 500FT TRANSITION APPROACHING THE UNDERPASS AREA

COUNTY OF	ITEM NO.	SHEET NO.
WARREN	3-199.00	

US 31W WIDENING  
DIVERSION #1  
UNDERPASS

SCALE: 1"= 50'